	<h1>924R</h1>	 <b>AGD</b> CERTIFIED INTELLIGENT DETECTION SYSTEM
	<b>LED SOLUTIONS</b>	
	SA-146 LED Wait Indicator SA-149 Higher Current Wait Indicator	

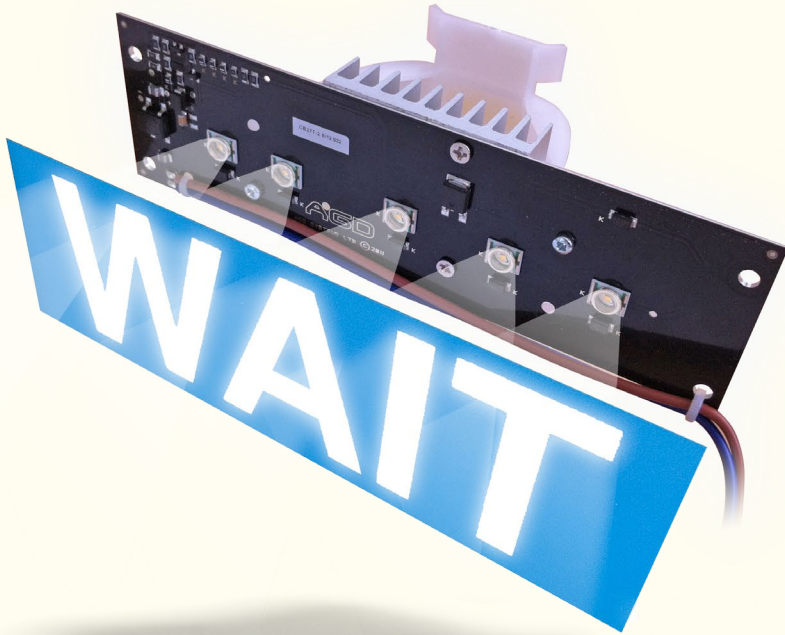

## PRODUCT MANUAL



# INSTALLATION

## OPTION 1

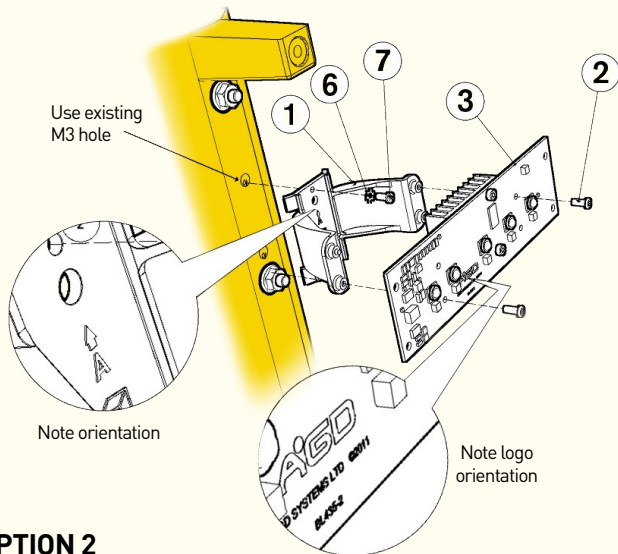

## OPTION 2

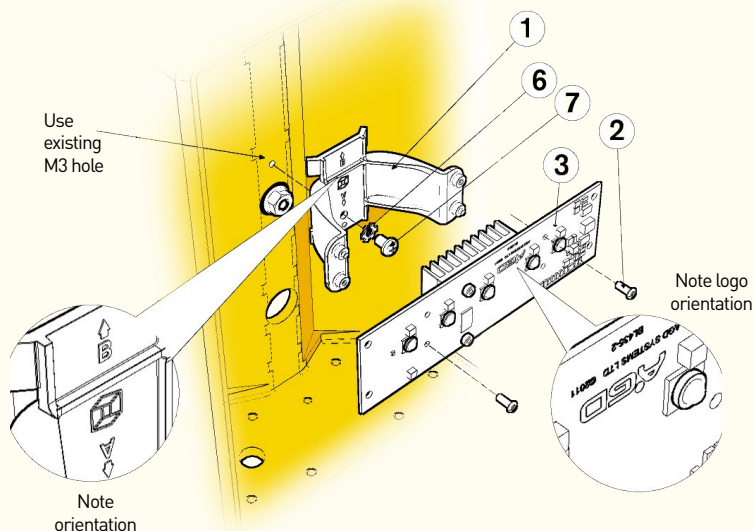

The bracket (BR-230) and pcb (CB-277/CB-318) are designed to cover a range of bulb wait housing options. For each of these the orientation of bracket and pcb are very specific as detailed in the diagrams above.

Please note particularly that the bracket has **two** orientations **marked A&B**.

1. Identify existing bulb unit as Option 1-4
2. Remove existing lamp configuration and wiring as appropriate
3. Remove the pcb CB-277/CB-318 from the bracket, keeping the screws to one side ensuring no contact is made directly with the LED's

# INSTALLATION

## OPTION 3

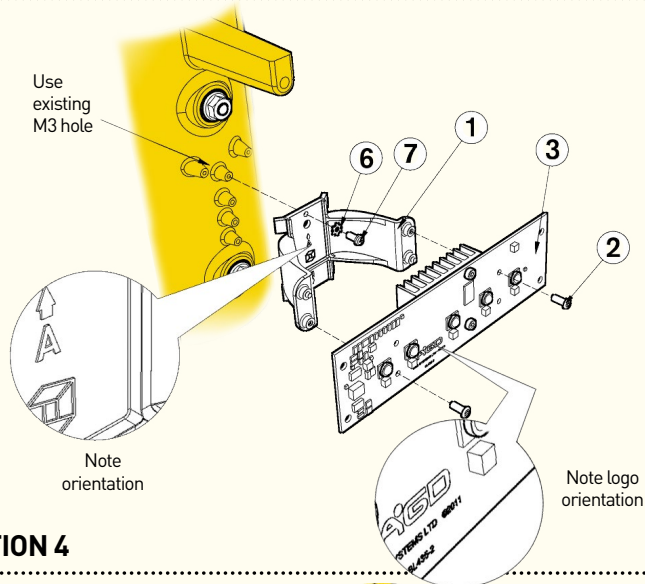

## OPTION 4

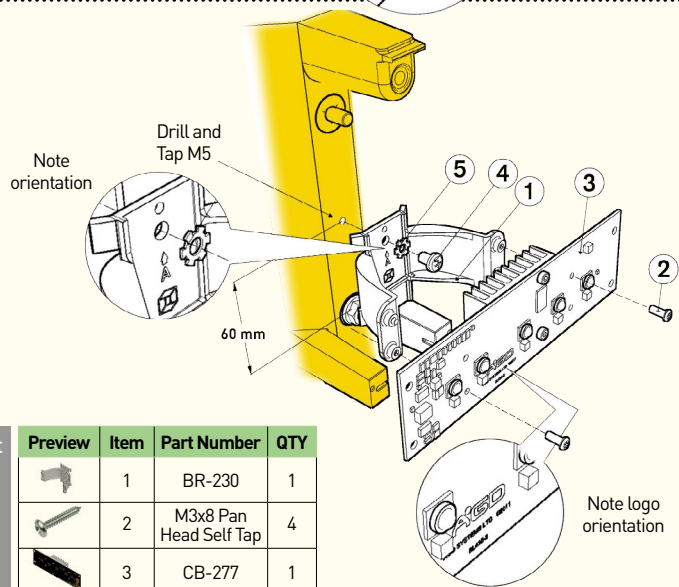

The LED wait retro fit kit (SA-146) is designed to replace existing bulb version Waits with a 48Vac low power LED pcb and comprises:

Preview	Item	Part Number	QTY
	1	BR-230	1
	2	M3x8 Pan Head Self Tap	4
	3	CB-277	1
	4	M5x8 Pan Head	1
	5	M5 Shk Proof	1
	6	M3 Shk Proof	1
	7	M3x6 Pan Head	1

4. Using the appropriate screw fixings secure the bracket BR-230 to the rear housing in the position shown
5. Refit the pcb to the bracket noting the orientation of the AGD logo on the pcb on the relevant diagram
6. Connect wiring per the table below

# INTRODUCTION

## SAFETY PRECAUTIONS

**Important note:** Do not touch the surface of the LED's. For maintenance purposes users should take particular care and avoid exposure to the high intensity LED light output. Although the

LED's are not laser devices they have a high brightness and thus to ensure maintenance engineer "eye-safety", DO NOT LOOK DIRECTLY INTO THE LEDS when opening the unit or powering the pcb.

The kit is supplied with the pcb **reversed** on the bracket to protect the LED's whilst in transit.



## POWER & WIRING

### CB-277 (fitted to AGD924-68X-XXX)

Wire Colour	Function	Nominal power consumption in bright mode
Red	48V ac	10.2W - 11.2W 48Vac.
Red	48V ac	

### CB-318 (fitted to AGD924-69X-XXX)

Wire Colour	Function	Nominal power consumption in bright mode
Red	48V ac	12.48W - 48Vac.
Red	48V ac	

The CB-318 consumes a nominally higher current than the CB-277. This is for controllers that require a nominally higher current for monitoring purposes. The CB-318 takes 71% and 25% more power in dim and bright modes.

## DISCLAIMER

While we (AGD Systems) endeavour to keep the information in this manual correct at the time of print, we make no representations or warranties of any kind, express or implied, about the completeness, accuracy, reliability, suitability or availability with respect to the information, products, services, or related graphics contained herein for any purpose.

Any reliance you place on such information is therefore strictly at your own risk. In no event will we be liable for any loss or damage including without limitation, indirect or consequential loss or damage, or any loss or damage whatsoever arising from loss of data or profits arising out of, or in connection with, the use of this manual.

## WARRANTY

All CB-277 and CB-318 retrofit pcb's are covered by a one year return to factory warranty. Products falling outside this period may be returned to AGD Systems for evaluation and chargeable repair.



### AGD Systems Limited

White Lion House  
Gloucester Road,  
Staverton, Cheltenham  
Gloucestershire, GL51 0TF, UK

T: +44 (0)1452 854212  
F: +44 (0)1452 854213  
E: sales@agd-systems.com  
W: agd-systems.com

